

FM Approved Dual Valve Sensors

Inductive Proximity Sensors for Installation in Class 1, Division 2



NON-HAZARDOUS LOCATION

HAZARDOUS (CLASSIFIED) LOCATION Class 1, Division 2, Groups A,B,C,D

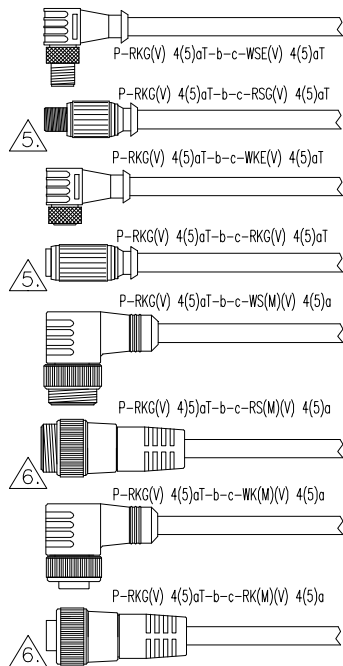

or
P-RKG(V) 4aT-b-c
Connected devices must supply the voltage specified in Table 1 on Sheet 2

or
P-RKG(V) 4(5)aT-b-c
Connected devices must supply the voltage specified in Table 1 on Sheet 2

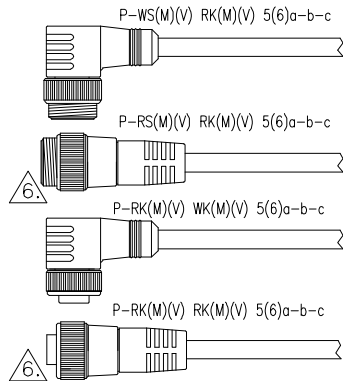

or
P-RKM(V) 5(6)a-b-c
Connected devices must supply the voltage specified in Table 1 on Sheet 2

or
P-RKM(V) 5(6)a-b-c
Connected devices must supply the voltage specified in Table 1 on Sheet 2

a = conductor color code
b = 3 digit ITC cable code
c = cable length in meters

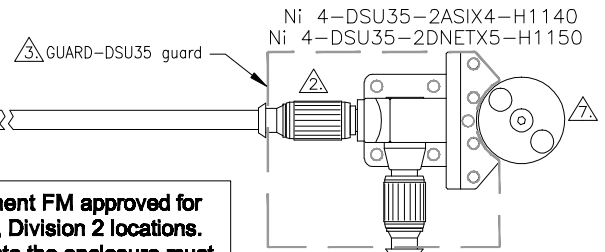
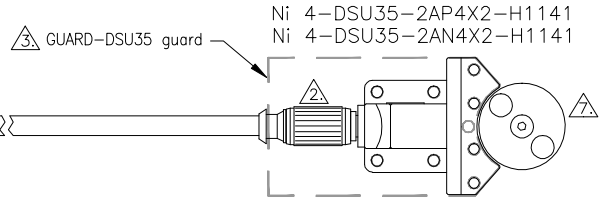

Equipment FM approved for Class I, Division 2 locations. Entry into the enclosure must be made via fittings approved for Class I, Division 2, or via FM approved Turck cordsets, receptacles, and lokfast guards.

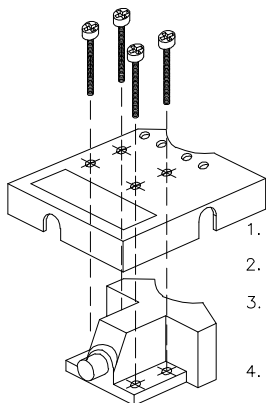
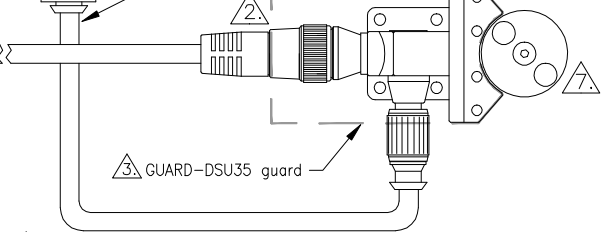
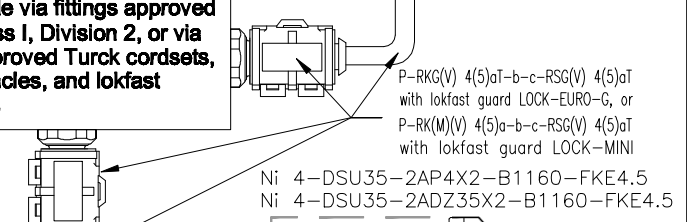

GUARD-DSU35.. Mounting Instructions

1. Position sensor in it's desired location.
2. Connect approved Turck cordset(s). Do not apply power.
3. Affix guard plate with screws provided. Ensure that the slots in the plate sides engage the connector body as shown.
4. Apply power. Do not remove the guard plate when the circuit is live.

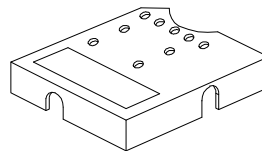

Kit #: GUARD-DSU35
Option: /S1717
Used with:
Ni 4-DSU35-2ASIX4
Ni 4-DSU35-2DNETX5
Kit #: GUARD-DSU35-DCS
Option: /S1727
Used with:
Ni 4-DSU35-2AP4X2-B1160-FKE4.5
Ni 4-DSU35-2ADZ35X2-B1160-FKE4.5

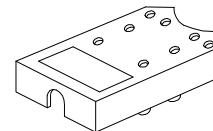

Kit #: GUARD-DSU35-DC
Option: /S1718
Used with:
Ni 4-DSU35-2AP4X2-H1140
Ni 4-DSU35-2AP4X2
Ni 4-DSU35-2AN4X2
Ni 4-DSU35-2ADZ35X2

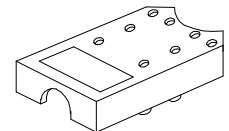

Kit #: GUARD-DSU35-AD
Option: /S1719
Used with:
Ni 4-DSU35-2ADZ35X2-B1151

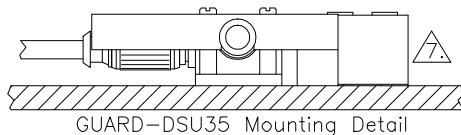

GUARD-DSU35 Mounting Detail

| | | | |
|---|--|---|--|
| Drawing No.: NI-1.002 | | 3000 Campus Drive Plymouth, MN 55441 Phone: (763) 553-7300 | |
| Title: Control Drawing for Dual Valve Sensors for Installation in Class I, Division 2 Hazardous Locations | | | |
| Scale: NONE | | Sheet 1 of 2 | |

| | | | |
|------------|---|-------------|----------------|
| C | Add Ni 4-DSU35-2ADZ35X2-B1160-FKE4.5, correct conn. code | BVL | 8/22/11 |
| B | Add 2AP4X2, 2DNETX5, and 2ADZ35X2 types | BVL | 6/16/05 |
| Rev | Description | Drft | Date |

FM Approved Dual Valve Sensors

Inductive Proximity Sensors for Installation in Class 1, Division 2



NON-HAZARDOUS LOCATION

HAZARDOUS (CLASSIFIED) LOCATION Class 1, Division 2, Groups A,B,C,D

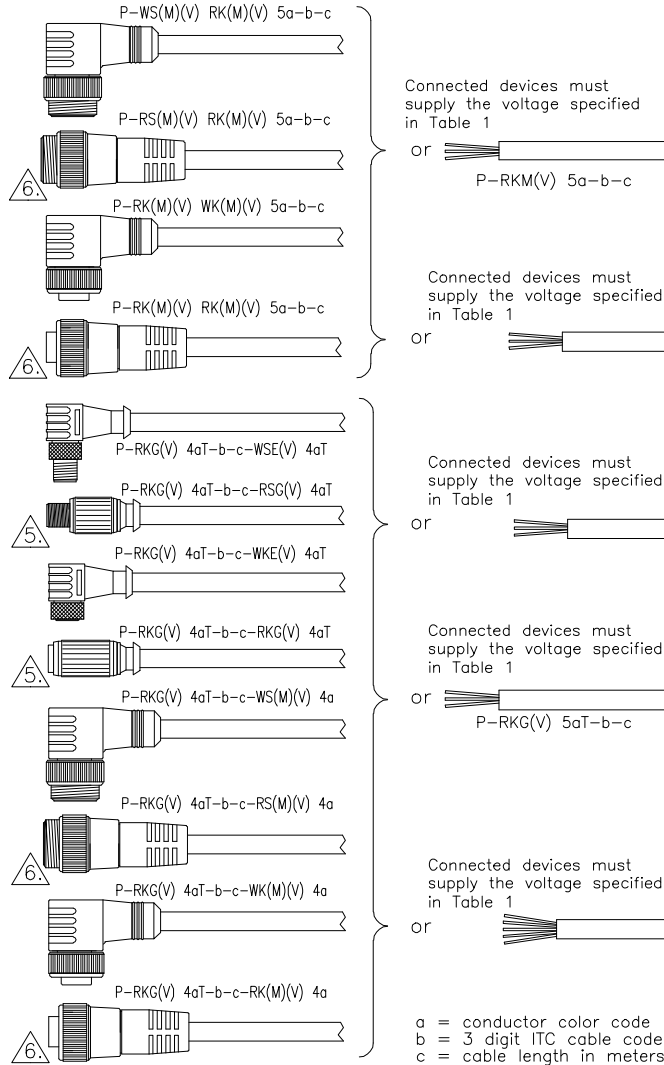
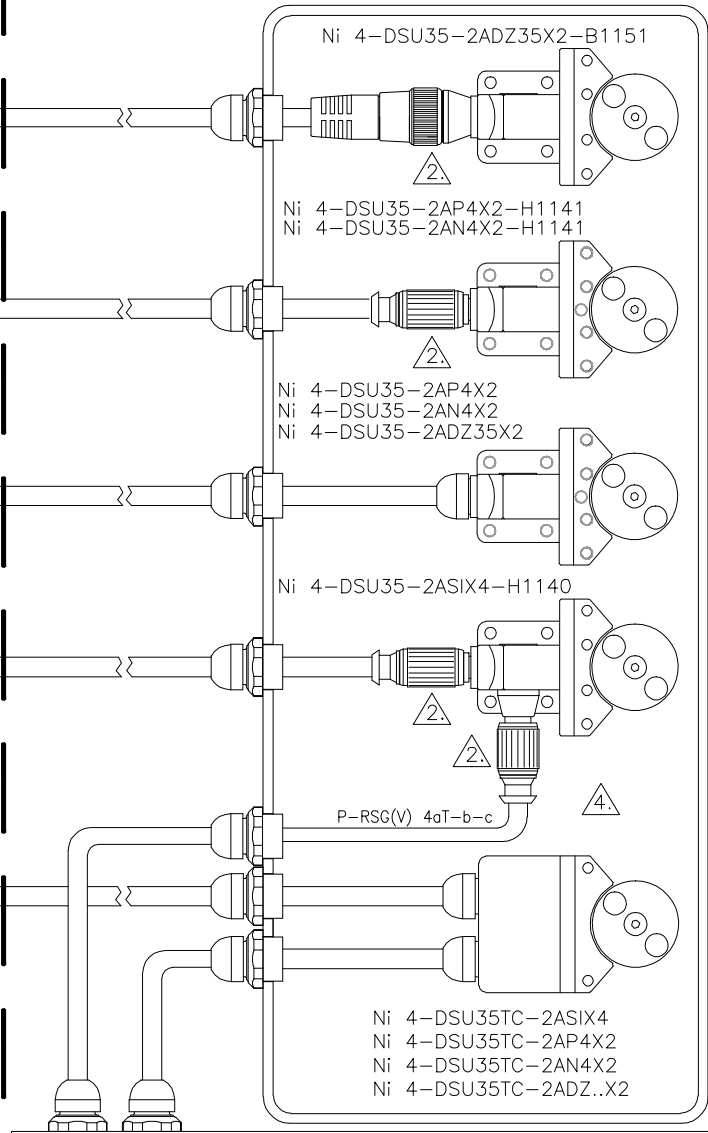

Table 1: Rated Supply Voltage

| Sensor Model | Rated Supply Voltage |
|---------------------------|----------------------|
| Ni 4-DSU35..-2ADZ35X2.... | 20-150 VUC |
| Ni 4-DSU35..-2AN4X2-... | 10-65 VDC |
| Ni 4-DSU35..-2AP4X2-... | 10-65 VDC |
| Ni 4-DSU35..-2ASIX4-... | 18-33 VDC |
| Ni 4-DSU35..-2DNETX5-... | 11-25 VDC |

a = conductor color code
b = 3 digit ITC cable code
c = cable length in meters



Equipment FM approved for Class 1, Division 2 locations. Entry into the enclosure must be made via fittings approved for Class 1, Division 2, or via FM approved Turck cordsets, and lokfast guards.

Notes:

- Wiring methods must be in accordance with Class 1, Division 2 wiring practices per the National Electrical Code (NEC), ANSI/NFPA 70, Article 501.4(B).
- Ni 4-DSU35-.....-H1140 and Ni 4-DSU35-.....-B1151 sensors must be connected using FM-approved Turck cordsets as shown. The cordsets FM approved for installation in Class 1, Division 2 when installed per Turck control drawing QCF-00147, available at www.turck.com/fmcd.
- GUARD-DSU35.. guards must be in place as shown on Sheet 1 when the circuit is energized. To obtain sensors with GUARD-DSU.. guard and hardware kits, add the option code to the end of the model number. To obtain the guard and hardware kit separately, order GUARD-DSU35, GUARD-DSU-DC, or GUARD-DSU35-AC appropriate to the sensor.
- Ni 4-DSU35-..... sensors may be installed without GUARD-DSU35.. guards if installed in a suitable equipment enclosure in accordance with ANSI/ISA S82.01 and S82.03.
- Straight eurofast and minifast connectors may be terminated in the hazardous location when used with approved Turck receptacles and LOCK-EURO-G lokfast guards.
- Straight minifast connectors shown may be terminated in the hazardous location when used with approved Turck receptacles and LOCK-MINI lokfast guards.
- Sensors not mounted in enclosures must be used with BTS-DSU35-... target pucks.

| | | | | | |
|------------|--|-------------|----------------|---------------------|-----------------|
| C | Add Ni 4-DSU35-2ADZ35X2-B1160-FKE4.5, correct conn. code | BVL | 8/22/11 | Drawing No.: | NI-1.002 |
| Rev | Description | Drft | Date | Scale: | NONE |
| | | | | Sheet | 2 of 2 |